

LAND-MARK SURVEYING

Mark L. Miritz

Wisconsin Professional Land Surveyor S-2582

N9330 Knuteson Drive
Whitewater, WI 53190
Phone: (262) 495-3284
MARKMIRITZ@
LAND-MARKSURVEYING.COM

NORTH 1/4 CORNER
SECTION 15-2-15

PLAT OF SURVEY

LOT 1 OF CERTIFIED SURVEY MAP NO. 1600, LOCATED
IN THE NORTHWEST 1/4 OF SECTION 15, TOWN 2 NORTH,
RANGE 15 EAST, DARIEN TOWNSHIP, WALWORTH COUNTY,
WISCONSIN.

OWNER: ADRIENNE D. WRIGHT
N3961 OLD HIGHWAY 89
DARIEN, WI 53114

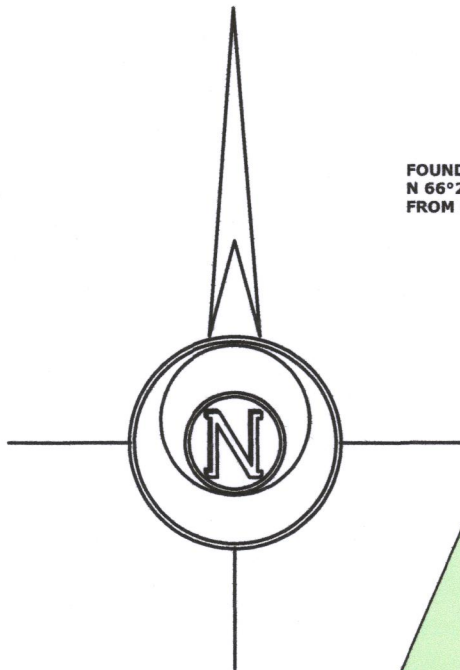

FOUND IRON PIPE BENT
N 66°29'19" W 0.69'
FROM CORNER

(S 89°19'54" E 256.53')
S 89°21'02" E 256.53'

223.53'

33.0'

1583.58'

(N 23°15'06" E 327.93')
N 23°16'20" E 327.93'

102.5'

124.8'

102.8'

100' SETBACK

30'
56' PROP
ADD

36.4'
24' PROP
ADD

40.4'
40.3'

SHED

SEPTIC

RESIDENCE

COVERED
PORCH

WELL

GRAVEL DRIVE

BARN

(150.17')
149.94'
S 89°18'39" W
(S 89°13'12" W)

100.7'

104.7'

10.9'

10.7'

175.8'

597.03'

(595.20')

595.11'
NORTH 2642.88'

OLD HIGHWAY "89"
(66' WIDE)

LOT 1

165,568 SQ. FT.
3.80 ACRES

145,906 SQ. FT.
3.35 ACRES
LESS RIGHT-OF-WAY

(N 02°26'24" W 309.52')
N 02°29'37" W 309.27'

189.88'
S 87°19'33" W 222.91'
(S 87°20' W 223.00')

33.03'

(464.29')
464.19'

CENTER OF SECTION 15-2-15

LEGEND



FOUND IRON PIPE



FOUND COUNTY MONUMENT

(xx)

RECORDED AS DIMENSION



EXISTING FENCE

SCALE: 1 INCH = 50 FEET

"I hereby certify that the above described property has
been surveyed by me or under my direction and that the
above map is a true representation thereof and shows the
size and location of the property, its exterior boundaries,
the location of all visible structures and dimensions of all
principal buildings thereon, boundary fences, apparent
easements, roadways and visible encroachments, if any."
"This survey is made for the use of the present owners of
the property, and also those who purchase, mortgage, or
guarantee the title thereto within one year from date
hereof."

Mark L. Miritz
MARK L. MIRITZ
WISCONSIN PROFESSIONAL
LAND SURVEYOR S-2582

DATE: APRIL 12, 2015

JOB NO. 15.402

REVISED AUGUST 31, 2022
TO SHOW PROPOSED SHED ADD

BA1600-1

215-869 912 310